

eMove[®]



Portable Charger

Mode 2 Type 2 16A

(EN) User manual

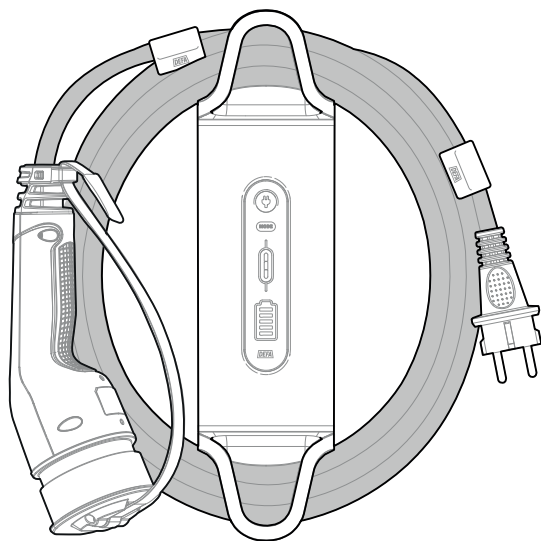

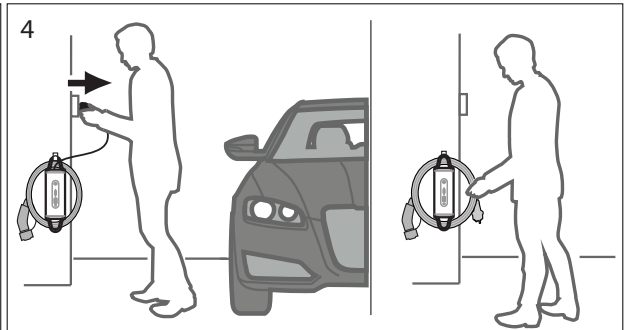
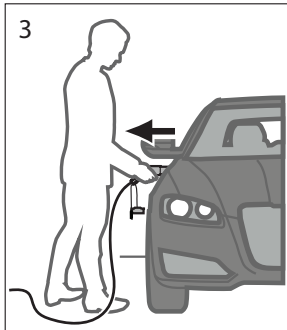
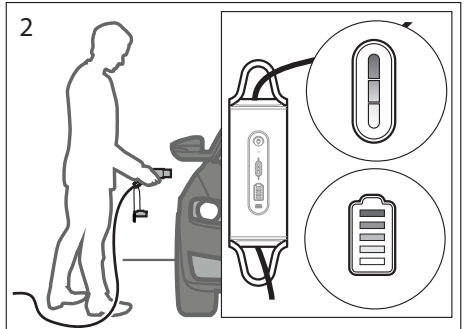
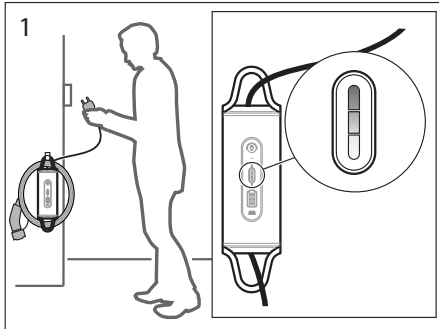

Table of Contents

Description	4
Safety information.....	5
Main parts	9
How to use the portable charger.....	11
Display symbols on the control box	14
Set the required charging power.....	16
Adjust Low mode manually.....	17
Store and protect	18
Maintenance and care.....	19
Error detection and solutions.....	20
Accessories and spare parts	22
Technical specification	23
Contact information	24

Description

eMove Portable Charger is a premium charger for electric vehicles and plug-in hybrids. The Portable Charger has been created with the user in mind. Unique features, unmatched user friendliness, and extreme durability characterizes eMove Portable Charger.

- Efficient cable management: Cable clips and guides keep the cable tidy.
- Robust and durable: Aluminum housing ensures a long product life, even in rough conditions.
- Easy to wind: The markets most flexible cable, even in temperatures down to -40°C .
- Flexible storing options: Use the bracket included with the product or hang from a hook.
- Safe power connection: A temperature sensor in the connector reduces and turns off charging.
- User-friendly: One-button interface and intuitive display.
- Power Adjustment: Manually reduces current to protect main fuse when necessary.

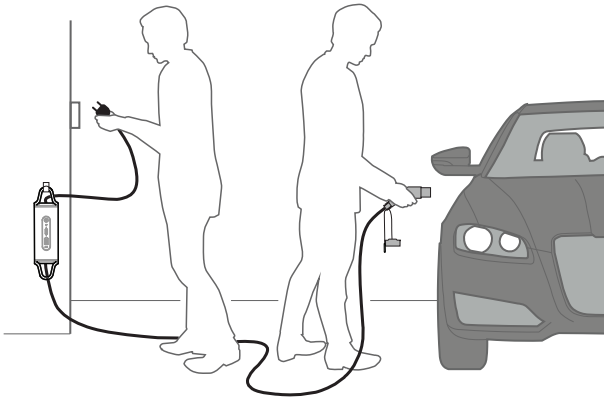

Safety information

Important! Read this document before using the device. Failure to follow any of the instructions or warnings can result in material damage or personal injury!

Important! If the device fails to behave according to instructions, immediately contact an electrician, responsible vendor or DEFA, see chapter **Contact information**.

Special notes



DANGER Sections marked with this symbol draw attention to electrical voltages that represent a danger to life and limb. Actions contrary to these safety notices may lead to severe or fatal injury. Actions marked with this symbol must not be carried out under any circumstances.



WARNING Sections marked with this symbol draw attention to additional hazards that may lead to damage to the cable itself or to other electrical devices. Actions marked with this symbol must be carried out with special care.



NOTICE Sections marked with this symbol draw attention to additional important information and special features that are necessary for the reliable operation of the device. Actions marked with this symbol should be carried out as required.

Danger

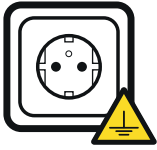

Only connect the charger to an earthed domestic outlet.



Do not plug the charger into a damaged, loose or worn domestic outlet.



Do not use the charger if it is defective or appears cracked, frayed, broken or otherwise damaged.



Do not use extension cord, multiple sockets or adapter.



Do not carry out repairs on the charger or try to open it in any way.

Warning

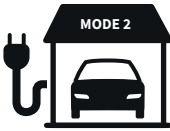

The portable charger is designed only for Mode 2 charging of vehicles. Do not use it for any other purpose.



Do not allow water to enter the domestic outlet or vehicle inlet while charging.



Do not insert the domestic plug if the domestic outlet is wet or covered in snow.



Keep the plugs away from water. Do not expose the plugs to a direct jet, or splashes of water.



Avoid exposing the portable charger to very hot temperatures.

Handling

Handle the portable charger with care and do not subject it to strong force or impact. Do not pull, twist, tangle, drag, or step on the cable.



DANGER Ensure that the cable is never run over by a vehicle.

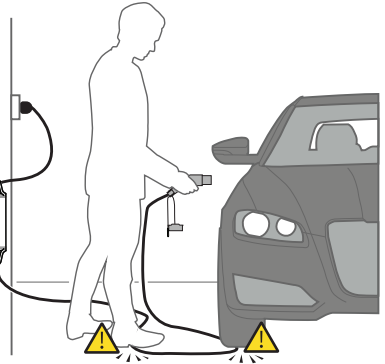
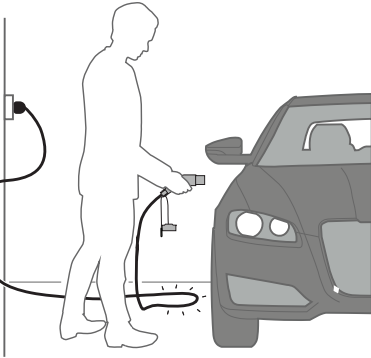

Always hold the cable by the handle when pulling it. Do not pull the cable itself.

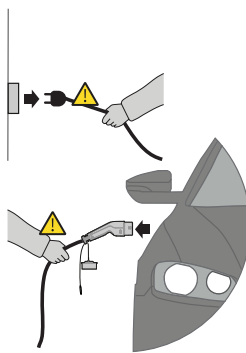
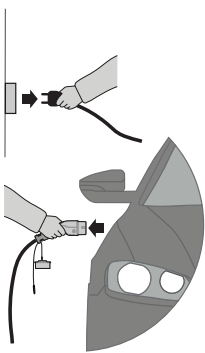

Storing

See chapter **Store and protect** for information about how to roll up the cable and how to attach the control box to the wall bracket.

- Always store with the cable rolled up. Do not leave the cable on the ground after usage.
- Always support the control box mechanically or manually. Do not let the control box hang from the domestic outlet unsupported.
- Attach the plug cap to protect the vehicle plug when storing the portable charger.
- Use the cable clips to coil the cable for storage or transportation.

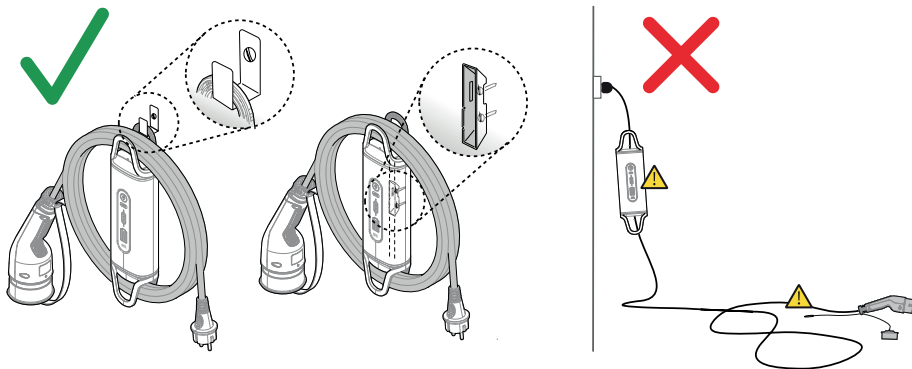

Main parts

- A. Plug cap with strap
- B. Vehicle plug
- C. Cable
- D. Control box
- E. Cable holder x 2
- F. Cable clip x 2
- G. Domestic plug

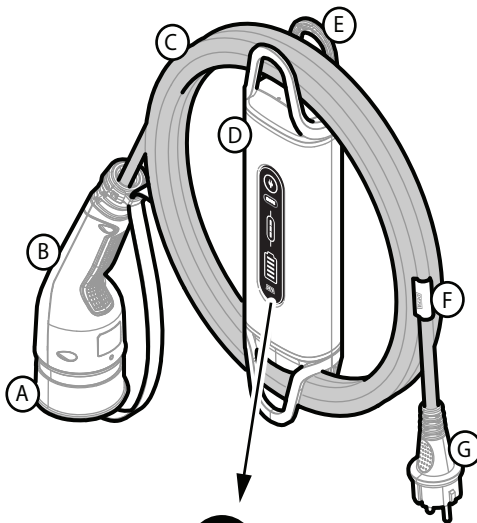

Display view

- H. Power Input Indication
 - J. Mode Button for power adjustment
 - K. Charger Status Indication
 - L. Vehicle Connection Indication
-

Also included: Wall bracket

Plugs

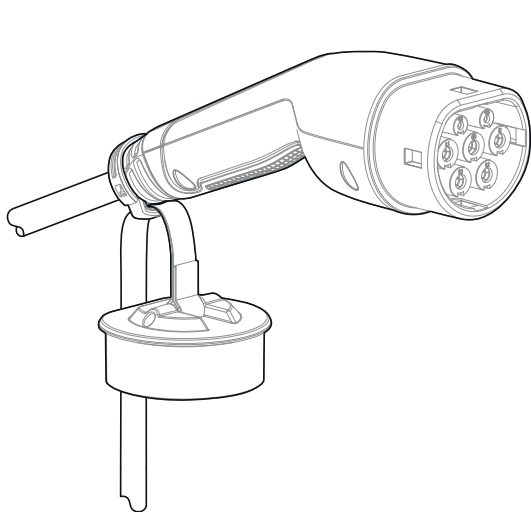

Vehicle plug Type 2 with plug cap and strap

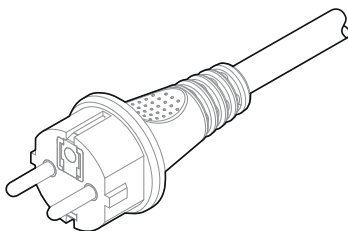

Domestic plug Type F Schuko

How to use the portable charger



NOTICE Please read the charging instructions in the vehicle's manual before using the charger.

Plug in

Check the condition of the domestic outlet and the vehicle inlet before inserting the plugs.

Always insert the plugs in the order described.

1. Insert the domestic plug into the domestic outlet. Automatic self-test will start and is indicated with flowing lights on Charger Status Indication.
2. Wait until the automatic self-test is finished. The bars on Charger Status Indication will be solid white.
3. Insert the vehicle plug into the vehicle inlet. Automatic self-test will start and is indicated with flowing lights on Charger Status Indication.

The vehicle will start charging.

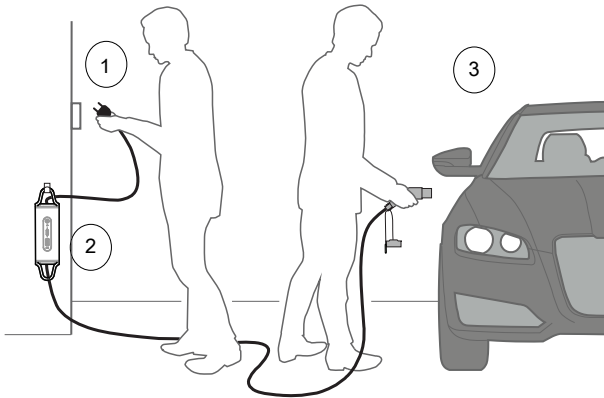

Use plug strap

The plug strap can adjust the cap's position. This prevents the cap from collecting water and dirt, and keeps the cap clear of the vehicle during charging.

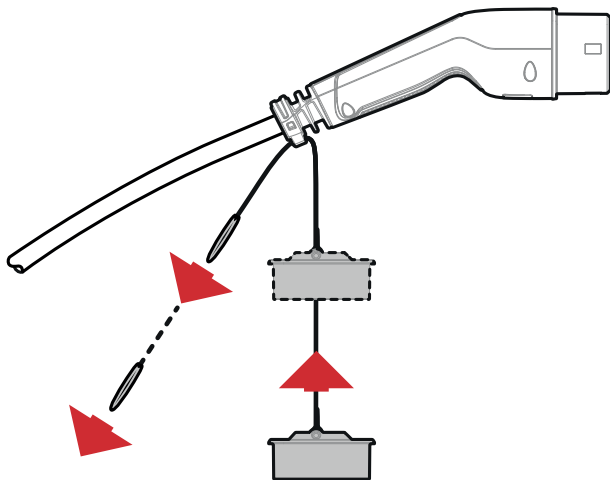

Proper connection

The plug must be fully inserted into the inlet of vehicle. Failure to do so will prevent the vehicle inlet from locking the plug in place and start charging.

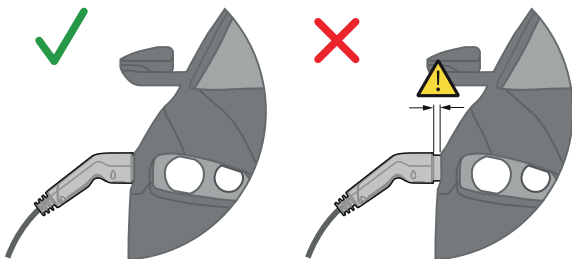

Unplug



WARNING Do not unplug the portable charger from the domestic outlet while the vehicle is charging. Complete or stop the charging before unplugging. To stop charging before vehicle is fully charged, see the vehicle's manual.

Always remove the plugs in the order described.

1. Remove the vehicle plug from the vehicle inlet.
2. Remove the domestic plug from the domestic outlet.

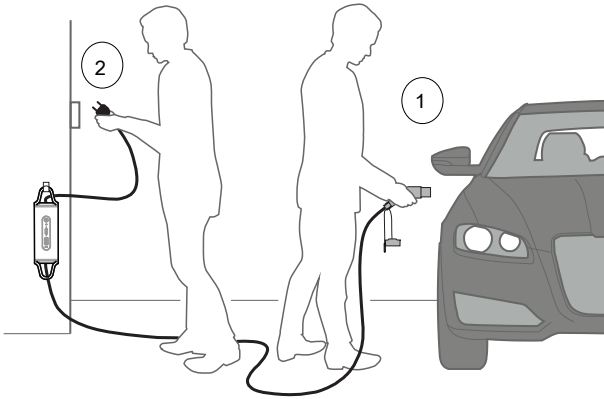

Display symbols on the control box



NOTICE To see animations that explains the different signals, go to www.defa.com or scan QR code on last page.

Power Input Indication

Indicates if the charger is connected to power or not.



No light – Power off



Light on – Power on



Pulsing - Charging finished



Pulsing red - Error

Mode Button for charging power adjustment

Press the Mode Button to toggle between Normal mode/Low mode. The modes will appear in the following order: Normal (default starting level) → Low → Normal →.

When the Mode Button is pressed the light will be lit for 5 seconds and then fade. Charger Status Indication will blink for 2 seconds, then stay lit.



No light - Normal mode



Light – Low mode is activated

Charger Status Indication



NOTICE This display does not view any information about the charging level of the vehicle's battery.

Indicates the control box setting. The display will blink for a few seconds at start-up and then settle on the current charging level for the device.



No light - Charger disconnected



Flowing - Automatic self-test



Two bars - Normal mode used



One bar - Low mode used



Pulsing - Charging finished
**



Pulsing red - Error

** Pulsing with one, two or three bars depending on chosen mode

Vehicle Connection Indication



NOTICE This display does not view any information about the charging level of the vehicle's battery.

Indicates that the portable charger is connected to the vehicle and that charging is in progress.



No light - No connection to vehicle



Only end lights lit - Battery connected (no charging yet)



Lights are lit in sequence - Charging*



Pulsing - Vehicle has communicated fully charged



Pulsing red - Error

*The speed in which the lights are lit indicates which mode is used.

Set the required charging power

1. Press the Mode Button to toggle between Normal mode/Low mode. The options will appear in the following order: Normal (default starting mode) → Low → Normal →.

A black oval button with the word "MODE" in white capital letters.

2. When setting the device to Low mode the Mode Button will be lit for 5 seconds and then fade. The amount of bars on Charger Status Indication show which of the modes is currently active.

A black oval button with the word "MODE" in white capital letters.

3. The Charger Status Indication will blink for 2 seconds until the change is effective, then stay lit.



NOTICE If charging ends on Low mode, this setting will be stored until the next use.

- **Low mode:** If Low mode is set, the charging level will be lower than normal. This might be required if the fuse for the domestic outlet is lower than the rating of the product. Or if the domestic outlets electrical circuit used for the portable charger is shared with other electrical products.

Charging power

Normal mode 16 A

Low mode, factory set 10 A

Adjust Low mode manually



WARNING The charger must only be plugged into the domestic outlet when doing this action. Do not plug into the vehicle inlet.

Tip! Adjusting is possible to do while inside a house, with the manual easily available.

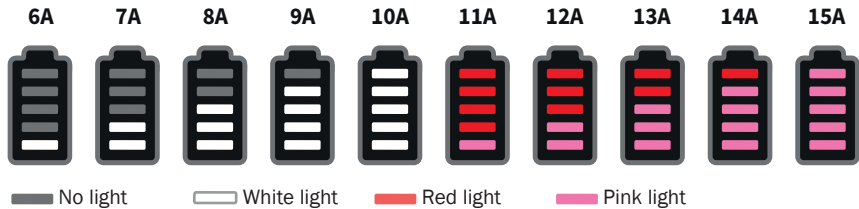

1. Connect the charger to a domestic outlet. Wait until the start-up sequence is finished.
2. Press and hold the Mode Button for about three seconds, until the Charger Status Indication symbol blinks white.
3. Press the Mode Button within five seconds to start setting the level.

It is possible to set the Low mode from the lowest level (6A) and up to one level below the normal level. The level will start at the earlier stored level and then move upward in 1A steps every time the button is pressed. After reaching the highest level to choose, the unit will return to the lowest level. The light on the display will indicate which level currently is chosen.

4. When the desired level is reached, wait 5 seconds. The new level is now stored.
5. The next time Low mode is used, this will be the pre-chosen level.

Store and protect

Wrap the cable

1. Roll the cable end with the vehicle plug around the control box. Ensure that the plug hangs with the plug cap facing the ground.
2. Roll the cable end with the domestic plug around the control box. Ensure that the plug hangs with the contacts facing the ground.

Hang the charger



WARNING Never hang the charger by the cable.

Use the included wall bracket to hang the charger. Attach the bracket to the wall according to the instructions included.

1. Wiggle and push the back of the control box onto the wall bracket.
2. Slide downward to attach the control box on the wall bracket.

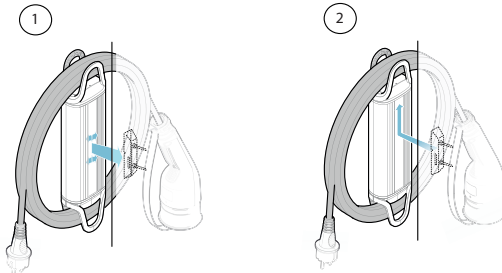

Tip! Use the upper rear cable holder to hang the control box on a wall hook or a similar feature.

Maintenance and care

Checking

- Keep the plugs dry and check them regularly for dust, dirt, pebbles, etcetera.
- Check the control box regularly for cracks and other damage.
- Check the cable regularly for cracks and other damage.
- Check the domestic outlet for damage and wear.
- Remove the plug from the domestic outlet when the charger is not in use.

Cleaning

- Unplug the portable charger before start cleaning.
- Use a damp cloth to clean. Do not use water or harsh chemicals.

Error detection and solutions

Vehicle side error



This error state will display if there is a problem on the vehicle side. This could be caused by the vehicle's battery, a faulty or damaged vehicle connection or a communications fault with vehicle.

A vehicle-side error state can be triggered at any time when the charger is connected to both a domestic outlet and a vehicle inlet. This includes during an active charge sequence, in charge-ready state or during start-up.

Try this

- Unplug the charger and then plug it in.
- Consult the vehicle's manual for information about possible issues.
- Contact the vehicle vendor.



This error state will display if there is a problem on the vehicle side of the control box. This could be caused by the cable not being connected correctly, a faulty or damaged vehicle connection or a damaged cable plug.

Try this

- Unplug the charger and then plug it in.
- Consult the vehicle's manual for information about possible issues.
- Contact the vehicle vendor.

Charger unit error



This error state will display if there is a problem detected with the internal electronics of the control box.

Try this

- Check if the control box is hot to the touch.
- Unplug the charger and wait a few minutes, then plug it in.
- Contact DEFA, see chapter **Contact Information**.



This error state will display if the charger is disconnected.

Try this

- Unplug the charger and then plug it in.
- Contact DEFA, see chapter **Contact Information**.

Domestic side error



This error state will display if there is a problem detected with the domestic power supply to the charger. This could include incorrect or fluctuating voltage, ground faults or other errors.

Try this

- Check if the control box or domestic plug is hot to the touch.
- Unplug the charger and wait a few minutes, then plug it in.
- Consult an electrician or contact DEFA, see chapter **Contact information**.



This error state will display if there is a problem detected with the domestic power supply to the charger

Try this

- Check that the power supply to the property is ok.
- Check that the domestic circuit breaker/fuse plug not has triggered.
- Consult an electrician.

Accessories and spare parts

Accessories

- Basic bag, Art. nr. 712593
- Premium bag, Art. nr. 712594
- Docking station, Art.nr. 712268



Spare parts

- Wall bracket
- Kit containing: cable clips and holder

Technical specification



WARNING Only use the portable charger in the country it is designed for.

Rated voltage	230 VAC (1-phase, 50-60Hz)	
Portable charger type	Mode 2	
Connection to vehicle	Type 2	
RCD	30 mA AC & 6mA DC	
GRID type	Seamless TN & IT grid	
Overheat protection	In ICCB & domestic plug	
Operating temperature	-40 °C to +50 °C	
Storage temperature	-50 °C to +85 °C	
Operational altitude	Maximum 4000 m above sea level	
Size ICCB (LxWxT)	310 x 85 x 55 mm	
Material control box (ICCB)	Aluminium with double protected plastic end caps	
IP rating vehicle plug	IP 67	
IP rating control box (ICCB)	IP 67	
Weight	2.1 kg	
Certification IEC	IEC 61851, IEC 62752, IEC 62196	
Recycling	EEE-waste	

Contact information

If you have any questions, contact DEFA support:

- Phone (Norway): +47 32 06 77 00
- Phone (Sweden): +46 10 498 38 00
- Phone (Finland): +358 (0)20 152 72 00

If you have any feedback on how the system or support can be improved, feel free to give us your input at connect@defa.com

